

Vertical Downlite DL 51

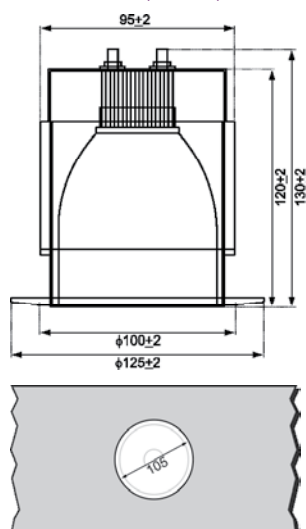

A compact vertical narrow beam downlighter suitable for incandescent lamp upto 60W or Retrofit CFLs 5W(DU)/ 8W(TU).

Dimensions (in mm)



Specification

Housing

MS powder coated black housing with white reflector holding reveted frame.

Optics

Spun aluminium, specular finish reflector with diamond pattern on upper half and vertical facets on lower half for better glare control.

Lamp Holder

B22-d ceramic lamp holder with electrical grade copper contacts provided as standard, wired upto terminal block mounted on adjustable frame.

Mounting

Fixed into false ceiling by means of 2 nos. SS spring clips provided as per instruction.

Applications

Showrooms
Restaurants
Hotel lobbies
Corridors & passage areas



Technical Details

Ordering Code	Lamp Type	Nominal Voltage (V)	Mains Current (A)	Lamp Socket	Power Factor
LHOL51160399	upto 1X60W GLS/	240	0.260	B22-d	1.00
	1x5W CFL Retro (DU)/	240	0.040	B22-d	≥0.50
	1x8W CFL Retro (TU)	240	0.060	B22-d	≥0.50



Vertical Downlite DL 53



A compact vertical narrow beam downlighter suitable for incandescent lamp upto 60W or retrofit CFLs 20W (TU) or 20W (Spiral).

Dimensions (in mm)

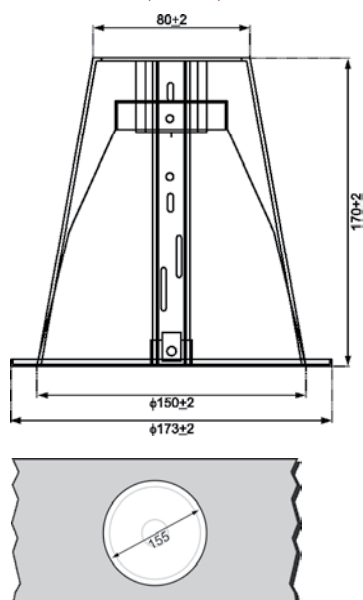

Specification

Housing

MS powder coated white housing with reflector holding reveted frame.

Optics

Spun aluminium, specular finish reflector with square pattern on top, diamond pattern for middle and vertical facets on lower portion for better glare control.

Lamp Holder

B22-d ceramic lamp holder with electrical grade copper contacts provided as standard wired upto terminal block mounted on top.

Mounting

Fixed into false ceiling by means of 2 nos. SS spring clips provided as per instruction.

Applications

Showrooms
Restaurants
Hotel lobbies
Corridors & passage areas



Technical Details

Ordering Code	Lamp Type	Nominal Voltage (V)	Mains Current (A)	Lamp Socket	Power Factor
LHOL53160399	upto 1X60W GLS/	240	0.260	B22-d	1.00
	1x11W CFL Retro (DU)/	240	0.090	B22-d	≥0.50
	1x20W CFL Retro (TU)/	240	0.165	B22-d	≥0.50
	1x20W CFL Retro (Spiral)	240	0.165	B22-d	≥0.50



Vertical Downlite DL 17



An integral compact vertical narrow beam downlighter suitable for single 18W (PL-C) non-retrofit compact fluorescent lamps for accentuating lighting effect.

Dimensions (in mm)

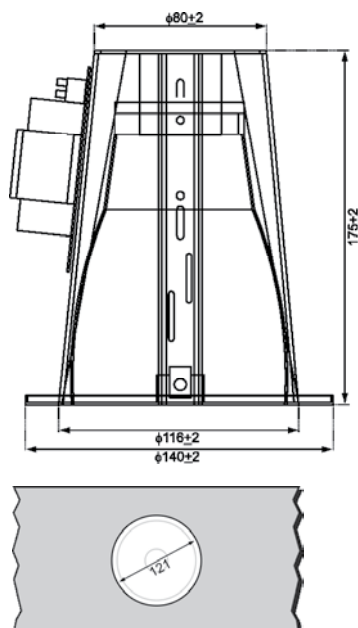

Specification

Housing

MS powder coated black housing with white reflector holding reveted frame.

Optics

Spun aluminium, specular finish reflector with square pattern on top, diamond pattern for middle and vertical facets on lower portion for better glare control.

Lamp Holder

White polycarbonate/ ABS lamp holder with electrical grade copper contacts.

Electric gear

Pre-wired with open construction copper wound ferromagnetic CFL ballast mounted on one of mounting legs upto terminal block. Option with light-weight high frequency electronic ballast available on request.

Mounting

Fixed into false ceiling by means of 3 nos. SS spring clips provided as per instruction.

Applications

Showrooms
Restaurants
Hotel lobbies
Corridors & passage areas



Technical Details

Ordering Code	Lamp Type	Nominal Voltage (V)	Mains Current (A)	Lamp Socket	Power Factor*
LHOC14118320	1x18W CFL (PL-C)	240	0.220	G24 d-2	≥0.50

* With HF electronic ballast option power factor ≥0.90.



Downlite DL 10



An integral compact horizontal wide beam downlighter suitable for single 18W (PL-C) non-retrofit compact fluorescent lamp.

Dimensions (in mm)

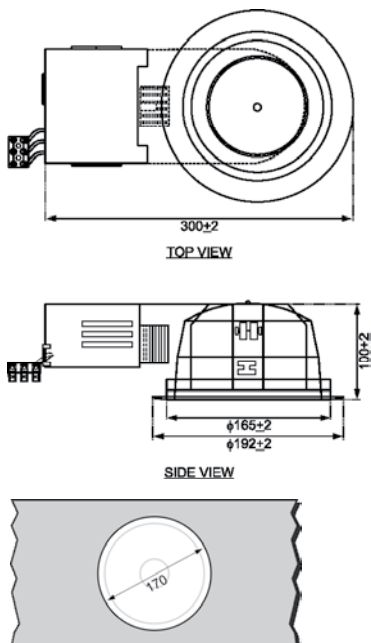

Specification

Housing

MS powder coated black housing with white reflector holding reveted frame.

Optics

Spun aluminium, specular finish reflector with square pattern on top, diamond pattern for middle and vertical facets on lower portion for better glare control.

Lamp Holder

White polycarbonate/ ABS lamp holder with electrical grade copper contacts.

Electric gear

Pre-wired with open construction copper wound ferromagnetic CFL ballast upto terminal block.
Option with light-weight high frequency electronic ballast available on request.

Mounting

Fixed into false ceiling by means of 2 nos. SS spring clips provided as per instruction.

Applications

Showrooms
Restaurants
Hotel lobbies
Corridors & passage areas

Technical Details

Ordering Code	Lamp Type	Nominal Voltage (V)	Mains Current (A)	Lamp Socket	Power Factor*
LHOC10118320	1x18W CFL (PL-C)	240	0.220	G24 d-2	≥0.50

* With HF electronic ballast option power factor ≥0.90.



Modular Downlite DL 12



A compact modular horizontal wide beam downlighter suitable for twin 18W (PL-C) non-retrofit compact fluorescent lamps.

Dimensions (in mm)

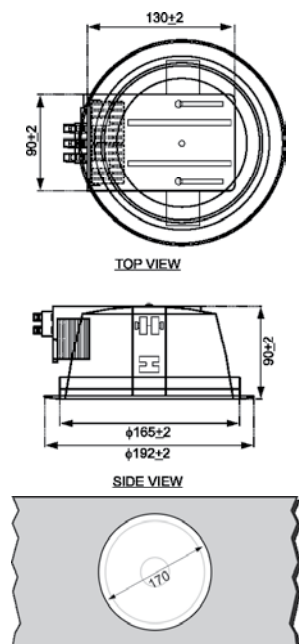

Specification

Housing

MS powder coated black housing with white reflector holding reveted frame.

Optics

Spun aluminium, matt finish reflector for better glare control.

Lamp Holder

White polycarbonate/ ABS lamp holder with electrical grade copper contacts.

Electric gear

Use suitable external control gear for selected lamp type & wattage.

Option with light-weight high frequency electronic ballast available on request.

Mounting

Fixed into false ceiling by means of 2 nos. SS spring clips provided as per instruction.

Applications

Showrooms
Restaurants
Hotel lobbies
High ceiling areas

Technical Details

Ordering Code	Lamp Type	Nominal Voltage (V)	Mains Current (A)	Lamp Socket	Power Factor*
LHOC12218399	2x18W CFL (PL-C)	240	0.440	G24 d-2	≥0.50

*When used with appropriate external modular DL tray fitted with electromagnetic ballast.
With HF electronic ballast option power factor ≥0.90.



Modular Downlite DL 15 N



A compact modular horizontal wide beam downlighter suitable for twin 13W/ 18W (PL-C) non-retrofit compact fluorescent lamps.

Dimensions (in mm)

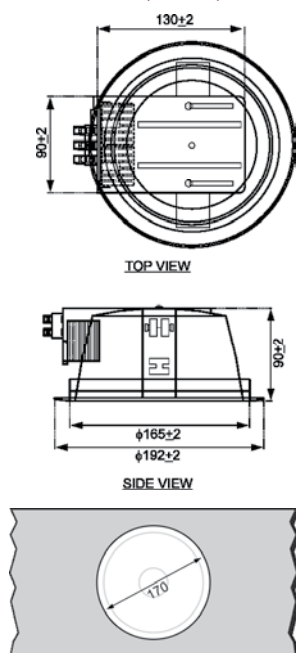

Specification

Housing

MS powder coated black housing with white reflector holding reveted frame.

Optics

Spun aluminium, specular finish reflector with square pattern on top, diamond pattern for middle and vertical facets on lower portion for better glare control.

Lamp Holder

White polycarbonate/ ABS lamp holder with electrical grade copper contacts.

Electric gear

Use suitable external control gear for selected lamp type & wattage.

Option with light-weight high frequency electronic ballast available on request.

Mounting

Fixed into false ceiling by means of 2 nos. SS spring clips provided as per instruction.

Applications

Showrooms
Restaurants
Hotel lobbies
High ceiling areas

Technical Details

Ordering Code	Lamp Type	Nominal Voltage (V)	Mains Current (A)	Lamp Socket	Power Factor*
LHOC14218399	2x13W CFL (PL-C)	240	0.350	G24 d-1	≥0.50
	2x18W CFL (PL-C)	240	0.440	G24 d-2	≥0.50

*When used with appropriate external modular DL tray fitted with electromagnetic ballast.
With HF electronic ballast option power factor ≥0.90.



Modular Downlite DL 33



A compact modular horizontal wide beam downlighter suitable for twin 13W/ 18W/ 26W (PL-C) non-retrofit compact fluorescent lamp with no glare frosted glass diffuser.

Dimensions (in mm)

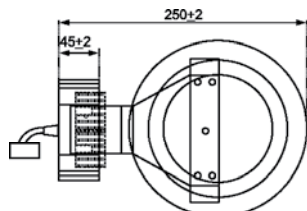

TOP VIEW

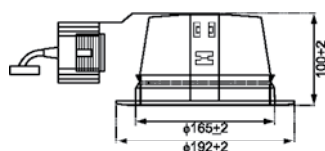

SIDE VIEW

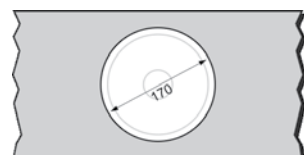

Specification

Housing

MS powder coated black housing with white reflector holding reveted frame.

Optics

Spun aluminium, specular finish reflector with "FROSTED" glass cover for diffused light. Glass cover fixed to a frame and frame held on to the housing with 3 SS latches. The glass assembly is provided with SS chain for re-lamping/ maintenance by pulling downwards.

Lamp Holder

White polycarbonate/ ABS lamp holder with electrical grade copper contacts.

Electric gear

Use suitable external control gear for selected lamp type & wattage.

Option with light-weight high frequency electronic ballast available on request.

Mounting

Fixed into false ceiling by means of 2 nos. SS spring clips provided as per instruction.

Applications

Toilets
Corners
Passages
Meeting rooms
Low level general lightings

Technical Details

Ordering Code	Lamp Type	Nominal Voltage (V)	Mains Current (A)	Lamp Socket	Power Factor*
LHOC33226399	2x13W CFL (PL-C)	240	0.350	G24 d-1	≥0.50
	2x18W CFL (PL-C)	240	0.440	G24 d-2	≥0.50
	2x26W CFL (PL-C)	240	0.640	G24 d-3	≥0.50

*When used with appropriate external modular DL tray fitted with electromagnetic ballast.
With HF electronic ballast option power factor ≥0.90.



Modular Downlite DL 25

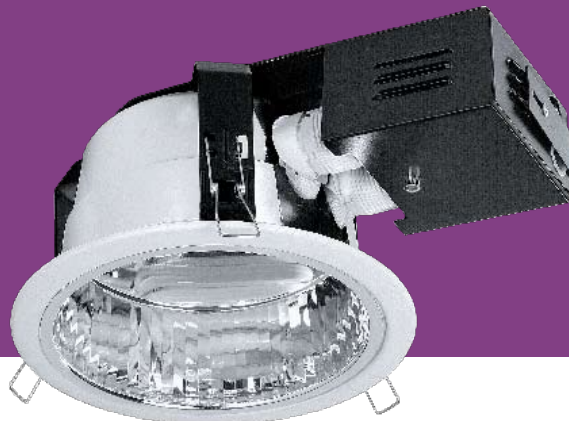

A compact modular horizontal wide beam downlighter suitable for twin 13W/ 18W/ 26W (PL-C) non-retrofit compact fluorescent lamps.

Dimensions (in mm)

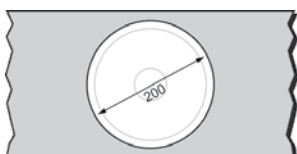
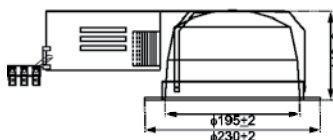
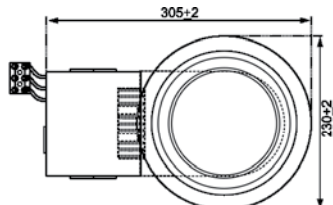

Specification

Housing

MS powder coated black housing with white reflector holding reveted frame.

Optics

Spun aluminium, specular finish reflector with dimpled pattern on top, plain finish for middle & vertical facets on lower portion for better light distribution & glare control.

Lamp Holder

White polycarbonate/ ABS lamp holder with electrical grade copper contacts.

Electric gear

Use suitable external control gear for selected lamp type & wattage.

Option with light-weight high frequency electronic ballast available on request.

Mounting

Fixed into false ceiling by means of 3 nos. SS spring clips provided as per instruction.

Applications

Showrooms
Restaurants
Hotel lobbies
High ceiling areas

Technical Details

Ordering Code	Lamp Type	Nominal Voltage (V)	Mains Current (A)	Lamp Socket	Power Factor*
LHOC25226399	2x13W CFL (PL-C)	240	0.350	G24 d-1	≥0.50
	2x18W CFL (PL-C)	240	0.440	G24 d-2	≥0.50
	2x26W CFL (PL-C)	240	0.640	G24 d-3	≥0.50

*When used with appropriate external modular DL tray fitted with electromagnetic ballast.
With HF electronic ballast option power factor ≥0.90.

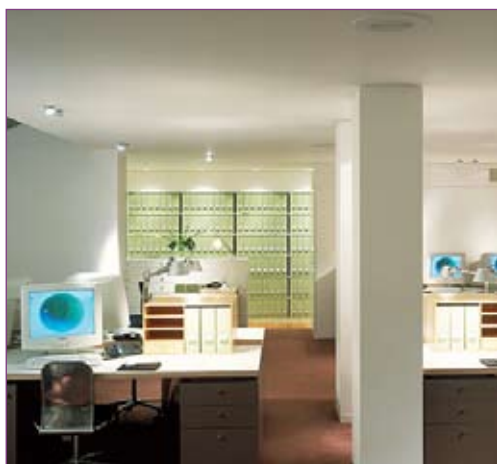

Modular Wall Washer DL 40



A compact modular horizontal wide beam wall washer suitable for twin 13W/ 18W (PL-C) non-retrofit compact fluorescent lamps.

Dimensions (in mm)

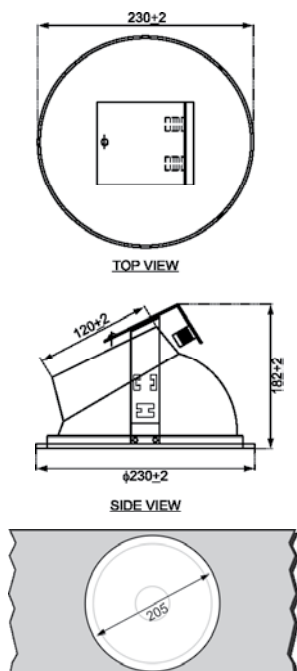

Specification

Housing

MS powder coated black housing with white reflector holding reveted frame.

Optics

Assymetric spun aluminium, specular finish reflector for better vertical illuminance.

Lamp Holder

White polycarbonate/ ABS lamp holder with electrical grade copper contacts.

Electric gear

Use suitable external control gear for selected lamp type & wattage.

Option with light-weight high frequency electronic ballast available on request.

Mounting

Fixed into false ceiling by means of 2 nos. SS spring clips provided as per instruction.

Applications

Showrooms
Restaurants
Hotel lobbies
Shopping precincts

Technical Details

Ordering Code	Lamp Type	Nominal Voltage (V)	Mains Current (A)	Lamp Socket	Power Factor*
LHOC40218399	2x13W CFL (PL-C)	240	0.350	G24 d-1	≥0.50
	2x18W CFL (PL-C)	240	0.440	G24 d-2	≥0.50

*When used with appropriate external modular DL tray fitted with electromagnetic ballast.
With HF electronic ballast option power factor ≥0.90.



Downlite DL 31



An integral ceiling/ surface mounted compact wide beam downlighter suitable for twin 18W (PL-C) non-retrofit compact fluorescent lamps.

Dimensions (in mm)

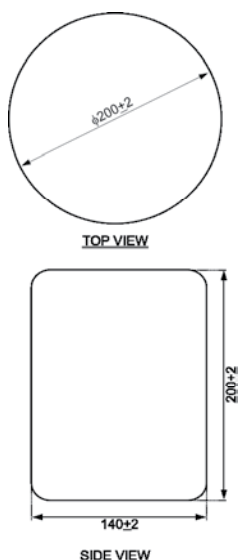

Specification

Housing

Made up of deep drawn MS body powder coated white finish.

Optics

Spun aluminium, specular finish reflector with dimpled pattern on top, and vertical facets on lower portion for better light distribution & glare control.

Lamp Holder

White polycarbonate/ ABS lamp holder with electrical grade copper contacts.

Electric gear

Pre-wired with twin open construction copper wound ferromagnetic CFL ballasts upto terminal block.

Option with light-weight high frequency electronic ballast available on request.

Mounting

Surface mounted by means of 4 nos screws.

Applications

Showrooms
Restaurants
Hotel lobbies
High ceiling areas



Technical Details

Ordering Code	Lamp Type	Nominal Voltage (V)	Mains Current (A)	Lamp Socket	Power Factor*
LHOC14218420	2x18W CFL (PL-C)	240	0.440	G24 d-2	≥0.50

* With HF electronic ballast option power factor ≥0.90.



Modular Downlite DL 34



A compact modular horizontal wide beam downlighter suitable for twin 13W/ 18W/ 26W (PL-C) non-retrofit compact fluorescent lamp with curved glass diffuser.

Dimensions (in mm)

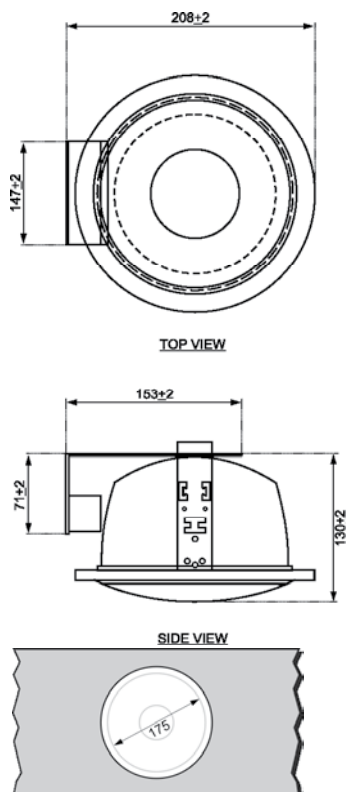

Specification

Housing

MS powder coated black housing with white reflector holding reveted frame.

Optics

Spun aluminium, specular finish reflector with "CURVED" glass cover for diffused light.

Lamp Holder

White polycarbonate/ ABS lamp holder with electrical grade copper contacts.

Electric gear

Use suitable external control gear for selected lamp type & wattage.

Option with light-weight high frequency electronic ballast available on request.

Mounting

Fixed into false ceiling by means of 2 nos. SS spring clips provided as per instruction.

Applications

Toilets
Corners
Passages
Meeting rooms
Low level general lightings

Technical Details

Ordering Code	Lamp Type	Nominal Voltage (V)	Mains Current (A)	Lamp Socket	Power Factor*
LHOC34226399	2x13W CFL (PL-C)	240	0.350	G24 d-1	≥0.50
	2x18W CFL (PL-C)	240	0.440	G24 d-2	≥0.50
	2x26W CFL (PL-C)	240	0.640	G24 d-3	≥0.50

*When used with appropriate external modular DL tray fitted with electromagnetic ballast.
With HF electronic ballast option power factor ≥0.90.



MH Downlite DL 22



Recess, circular, compact, non-integral downlighter suitable for single 150W ceramic/quartz metal halide double ended lamp.

Dimensions (in mm)

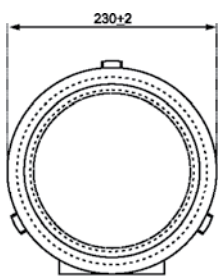

TOP VIEW

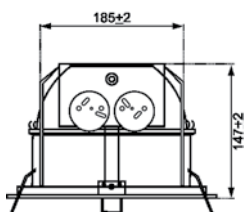

SIDE VIEW

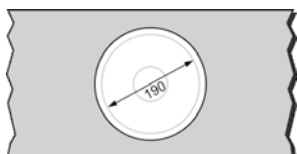

Specification

Housing

MS powder coated black housing with white reflector holding reveted frame.

Optics

Drawn aluminium, matt finish parabolic profile reflector with heat resistant toughened frosted glass for better light distribution, glare and heat control.

Lamp Holder

Rx7s ceramic lamp holder with electrical grade copper contacts.

Electric gear

Use suitable external control gear for selected lamp type & wattage.

Mounting

Fixed into false ceiling by means of 2 nos. SS spring clips provided as per instruction.

Applications

Showrooms
Restaurants
Hotel lobbies
Shopping malls
High ceiling areas

Technical Details

Ordering Code	Lamp Type	Nominal Voltage (V)	Mains Current (A)	Lamp Socket	Power Factor*
LHOM22115399	1x150W MH DE	240	0.82	Rx7s	≥0.85

*When used with appropriate external control gear box/ CGU.



MH Downlite DL 23



Recess, circular, compact, non-integral downlighter suitable for single 70W/ 150W ceramic/quartz metal halide double ended lamp.

Dimensions (in mm)

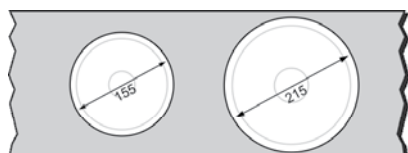
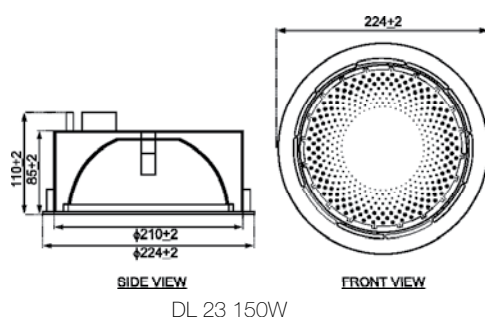
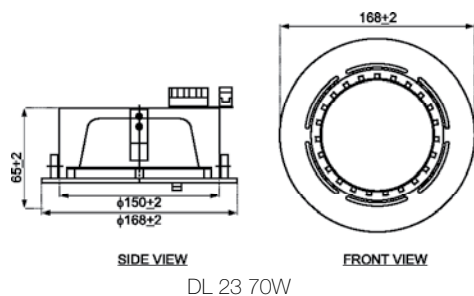

Specification

Housing

Pressure die-cast aluminium housing with glass retaining ring, in powder coated white finish. MS fitting holder bracket offered with powder coated black.

Optics

Drawn aluminium, matt finish parabolic profile reflector with heat resistant toughened glass for better light distribution, glare and heat control.

Lamp Holder

Rx7s ceramic lamp holder with electrical grade copper contacts.

Electric gear

Use suitable external control gear for selected lamp type & wattage.

Mounting

Fixed into false ceiling by means of 2 nos. SS spring clips provided as per instruction.

Applications

Showrooms
Restaurants
Hotel lobbies
Shopping malls
High ceiling areas

Technical Details

Ordering Code	Lamp Type	Nominal Voltage (V)	Mains Current (A)	Lamp Socket	Power Factor*
LHOM04170099	1x70W MH DE	240	0.40	Rx7s	≥0.85
LHOM04115099	1x150W MH DE	240	0.82	Rx7s	≥0.85

*When used with appropriate external control gear box/ CGU.



MH Wall Washer DL 24



Recess, rectangular, swivel, non-integral wall-washer suitable for single 70W/ 150W ceramic/ quartz metal halide double ended lamp.

Dimensions (in mm)

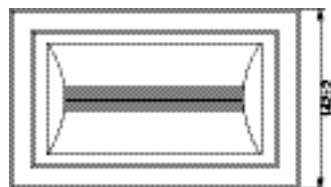

FRONT VIEW

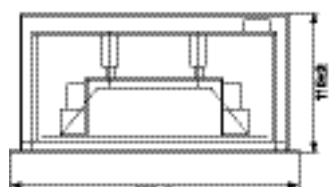

SIDE VIEW



Specification

Housing

Pressure die-cast aluminium housing with glass retaining frame, in powder coated white finish. MS fitting holder bracket offered with powder coated black.

Optics

Spun aluminium, anodised, matt finish reflector with heat resistant toughened glass for better light distribution & glare control.

Lamp Holder

Rx7s ceramic lamp holder with electrical grade copper contacts.

Electric gear

Use suitable external control gear for selected lamp type & wattage.

Mounting

Fixed into false ceiling by means of 2 nos. SS spring clips provided as per instruction.

Applications

Showrooms
Restaurants
Hotel lobbies
Shopping malls
High ceiling areas

Technical Details

Ordering Code	Lamp Type	Nominal Voltage (V)	Mains Current (A)	Lamp Socket	Power Factor*
LHOM24170399	1x70W MH DE	240	0.40	Rx7s	≥0.85
LHOM24115399	1x150W MH DE	240	0.82	Rx7s	≥0.85

*When used with appropriate external control gear box/ CGU.



GDL 20/GDL 21/GDL 33



Engineered to offer un compromised visual comfort in restricted spaces.

Dimensions (in mm)

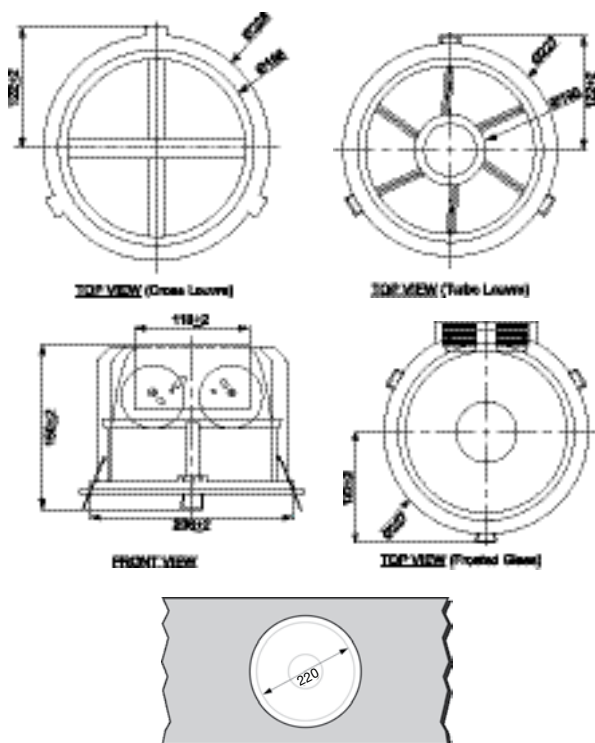

Specification

Housing

Pressure die-cast aluminium powder coated black finish frame with powder coated MS bracket for holding reflector and lamp holders.

Optics

High purity anodized aluminium reflector having satin finish provided with following options:

1. Cross louvre - for limited glare light distribution
2. Turbo louvre - for glare free light distribution
3. Frosted glass - for uniform light distribution

Lamp Holder

G-24d-3 lamp holder with electrical grade copper contacts.

Mounting

Fixed into false ceiling by means of 3 nos SS spring clips provided as per instruction.

Applications

Showrooms
Restaurants
Hotel Lobbies
Call Centre & BPO's
Corridors & Passage Areas

Technical Details

Ordering Code	Lamp Type	Nominal Voltage (V)	Mains Current	Lamp Socket	Power* Factor	Optics
LHOC70226399	2x26 W PL-C	240	0.640	G24d-3	≥ 0.5	Cross
LHOC71226399	2x26 W PL-C	240	0.640	G24d-3	≥ 0.5	Turbo
LHOC72226399	2x26 W PL-C	240	0.640	G24d-3	≥ 0.5	Soft Glass

*With magnetic DL Tray, order separately.

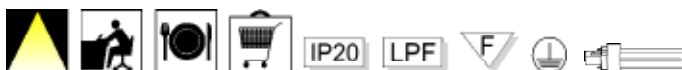

GDL 30



Uniquely square profiled, modular compact non-integral downlighter suitable for 2x26W CFL with patterned frosted glass.

Dimensions (in mm)

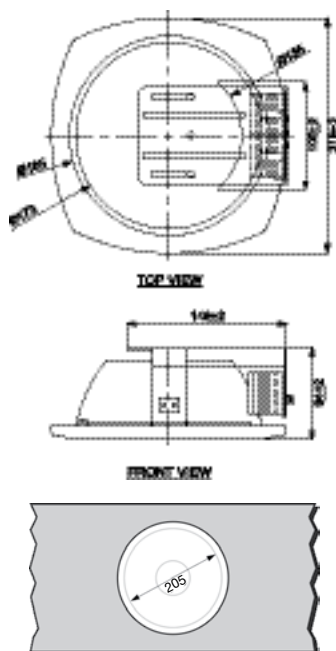

Specification

Housing

Pressure die-cast aluminium powder coated white finish frame with powder coated MS bracket for holding reflector and lamp holders.

Optics

Spun aluminium reflector having specular finish with patterned glass for glare free light distribution.

Lamp Holder

G-24 d3 lamp holder with electrical grade copper contacts.

Mounting

Fixed into false ceiling by means of 2 nos SS spring clips provided as per instruction.

Applications

Showrooms
Restaurants
Hotel lobbies
Call centres & BPO's
Corridors & passage areas



Technical Details

Ordering Code	Lamp Type	Nominal Voltage (V)	Mains Current	Lamp Socket	Power* Factor
LHOC73226399	upto 2x26 W PL-C	240	0.640	G24d-3	≥ 0.5

*With magnetic DL Tray, order separately.



GDL 35



A compact modular downlighter with accentuating projected drop lense arrangement suitable for 2x26W PL-C lamp.

Dimensions (in mm)

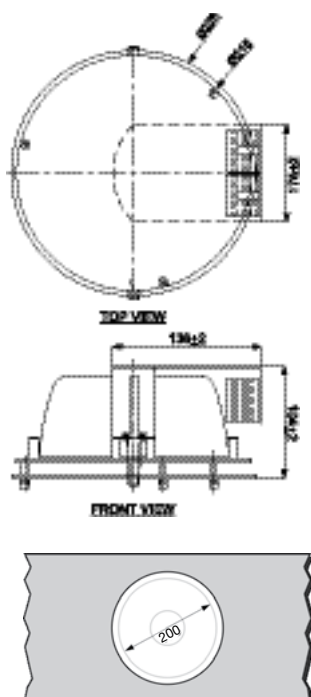

Specification

Housing

Pressure die-cast aluminium powder coated white finish frame with powder coated MS bracket for holding reflector and lamp holders.

Optics

Spun aluminium reflector having specular finish with projected semi frosted glass for effective light distribution and glare elimination.

Lamp Holder

G-24 d3 Lamp holder with electrical grade copper contacts.

Mounting

Fixed into false ceiling by means of 2 nos SS spring clips provided as per instruction.

Applications

Showrooms
Restaurants
Hotel Lobbies
Call Centres & BPO's
Malls and Retail Stores
Corridors & Passage Areas

Technical Details

Ordering Code	Lamp Type	Nominal Voltage (V)	Mains Current	Lamp Socket	Power* Factor
LHOC74226399	2x26W PLC	240	0.640	G24d-3	≥ 0.5

*With magnetic DL Tray, order separately.



GDL 70



A compact modular downlighter with accentuating projected drop lense arrangement suitable for 70W Metal Halide double ended lamp.

Dimensions (in mm)

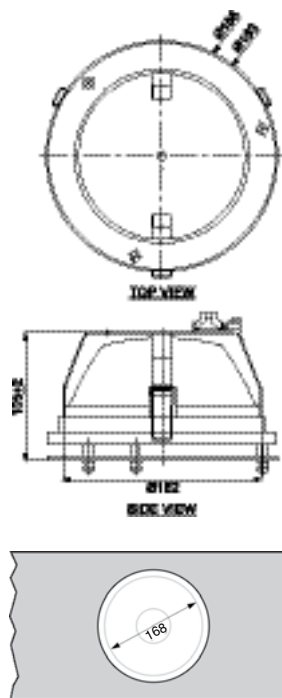

Specification

Housing

Pressure die-cast aluminium powder coated white finish frame with powder coated MS bracket for holding reflector and lamp holders.

Optics

Spun aluminium reflector having satin finish with projected & protected heat resistant toughened clear glass for optimum light distribution and heat control.

Lamp Holder

Rx7s ceramic lamp holder with nickel plated electrical grade copper contact.

Mounting

Fixed into the ceiling with 2 nos SS spring arrangement provided as per instruction

Applications

Showrooms
Restaurants
Hotel Lobbies
Call Centres & BPO's
Malls and Retail Stores
Corridors & Passage Areas

Technical Details

Ordering code	Lamp Type	Nominal Voltage (V)	Mains Current (A)	Lamp Socket	Power* Factor	Capacitor value
LHOM74170399	70W MH-DE	240	0.400	Rx7s	≥ 0.85	10 Mfd

*With CGU, order separately.



GDL 71



A compact modular downlighter with accentuating projected drop lense arrangement suitable for 150W Metal Halide double ended lamp.

Dimensions (in mm)

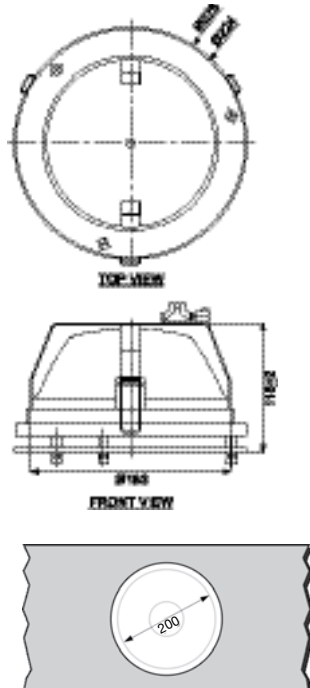

Specification

Housing

Pressure die-cast aluminium powder coated white finish frame with powder coated MS bracket for holding reflector and lamp holders.

Optics

Spun aluminium reflector having satin finish with projected & protected heat resistant toughened clear glass for optimum light distribution and heat control.

Lamp Holder

Rx7s ceramic lamp holder with nickel plated electrical grade copper contact.

Mounting

Fixed into the ceiling with 2 nos SS spring arrangement provided as per instruction

Applications

Showrooms
Restaurants
Hotel Lobbies
Show Windows
Call Centres & BPO's
Malls and Retail Stores
Corridors & Passage Areas

Technical Details

Ordering code	Lamp Type	Nominal Voltage (V)	Mains Current (A)	Lamp Socket	Power* Factor	Capacitor value
LHOM74115399	1x150MHDE	240	0.80	Rx7s	≥ 0.85	20 Mfd

*With CGU, order separately.



GDL Wall Washer



Recess modular
downlighter wall
washer for single
70W/ 150W MHSEQ
/ CDM-T

Dimensions (in mm)

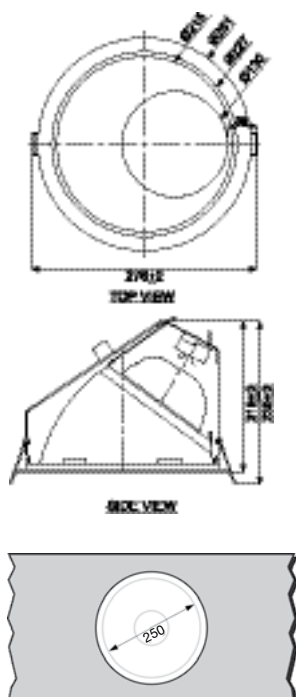

Specification

Housing

Pressure die-cast aluminium powder coated white finish frame with powder coated MS bracket for holding reflector and lamp holder.

Optics

High purity anodized aluminium reflector having satin finish with protected centre frosted. heat resistant, toughened glass for glare free extra optimum light distribution.

Lamp Holder

G12 ceramic lamp holder with tin plated electrical grade copper contact.

Mounting

Fixed into false ceiling by means of 2 nos SS spring clips provided as per instruction.

Applications

Showrooms
Restaurants
Hotel Lobbies
Show Windows
High Ceiling Areas
Call Centres & BPO's
Malls and Retail Shops
Corridors & Passage Areas

Technical Details

Ordering code	Lamp Type	Nominal Voltage (V)	Mains Current (A)	Lamp Socket	Power* Factor	Capacitor value
LHOM75170399	1x70W MHSEQ/CDM-T	240	0.400	G12	≥ 0.85	10 Mfd

*With CGU, order separately.



GDL 72



Recess, swivel modular wall-washer suitable for single 70W MH SEQ/CDM-T.

Dimensions (in mm)

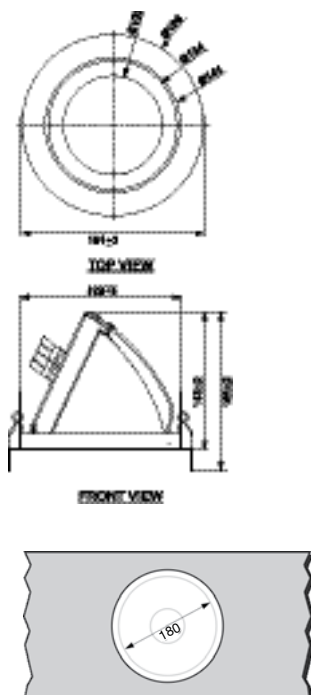

Specification

Housing

Powder coated white die cast aluminium housing with MS brackets high purity anodized reflector and frosted glass fixed to the frame.

Optics

High purity anodized aluminium having satin finish provided with heat resistant frosted toughened lense for glare elimination and diffused light distribution with angle adjustable system.

Lamp Holder

G12 ceramic lamp holder with electrical grade copper contact provided with stranded wire.

Mounting

Fixed into false ceiling with 2 nos clamp arrangement provided as per instruction.

Applications

Showrooms
Restaurants
Hotel Lobbies
Car Showrooms
Call Centres & BPO's
Malls and Retail Stores
Corridors & Passage Areas

Technical Details

Ordering code	Lamp Type	Nominal Voltage (V)	Mains Current (A)	Lamp Socket	Power* Factor	Capacitor value
LHOM76115399	1x70W MHSEQ/CDM-T	240	0.40	G12	≥ 0.85	10 Mfd

*With CGU, order separately.

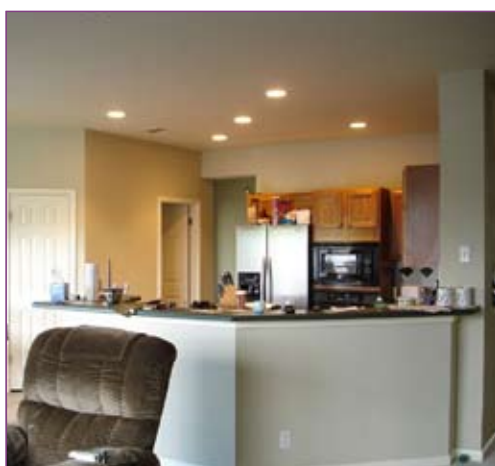

GDL 73



Recess, swivel
modular wall-washer
suitable for single
150W MH SEQ/
CDM-T.

Dimensions (in mm)

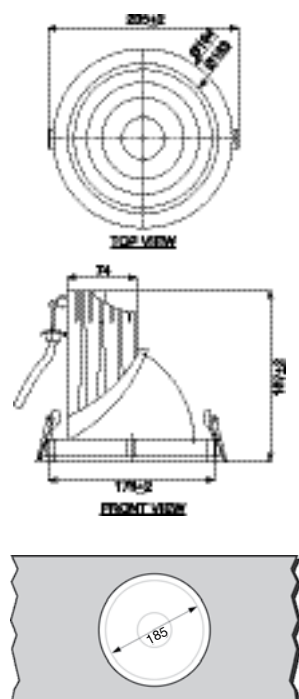

Specification

Housing

Powder coated white die cast aluminium housing with MS brackets high purity anodized reflector and frosted glass fixed to the frame.

Optics

High purity anodized aluminium having satin finish provided with heat resistant toughened lense with glare spot for glare elimination and crisp light distribution. Ideal optic for accent lighting applications.

Lamp Holder

G12 ceramic lamp holder with electrical grade copper contact provided with stranded wire.

Mounting

Fixed into false ceiling with suitable clamp arrangement provided as per instruction.

Applications

Showrooms
Restaurants
Art Galleries
Hotel Lobbies
Retail Lighting
Car Showrooms
Call Centres & BPO's
Malls and Retail Stores
Corridors & Passage Areas

Technical Details

Ordering code	Lamp Type	Nominal Voltage (V)	Mains Current (A)	Lamp Socket	Power* Factor	Capacitor value
LHOM76115399	1x150W MHSEQ/CDM-T	240	0.820	G12	≥ 0.85	20 Mfd

*With CGU, order separately.



GDL 60



Recess, swivel
modular downlighter
suitable for
1xQR111/ INNOVA
111

Dimensions (in mm)

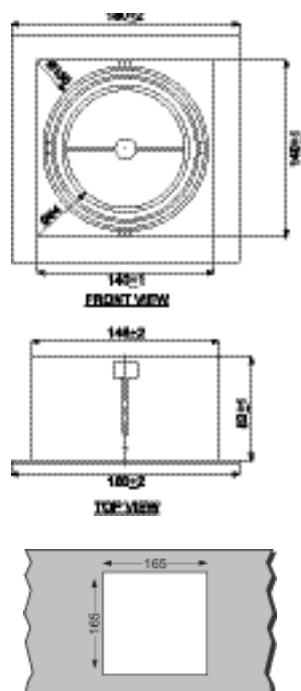

Specification

Housing

MS powder coated black housing with silver coated pressure die-cast aluminium ring and ring nut in silver ring. The arrangement provided for orientation of 45° in all direction.

Optics

The luminarie suitable for QR 111 and Innova 111 lamps with integrated reflector.

Lamp Holder

G53 / GU 5.3 type lamp holder with electrical grade copper contact.

Mounting

Fixed in false ceiling with suitable clamp arrangement provided as per instruction.

Applications

Showrooms
Restaurants
Art Galleries
Hotel Lobbies
Car Showrooms
Malls and Retail Shops

Technical Details

Ordering Code	Lamp Type	Nominal Voltage (V)	Mains Current (A)	Lamp Socket	Power* Factor
LHOH80150399	1x50W QR111	240	0.40	G53	1.0
	or 1x18W INNOVA 111	240	0.13	GU 5.3	≥ 0.55

*Order suitable ballast for Innova 111 separately.



GDL 61



Recess, swivel
modular downlighter
suitable for
2xQR111/ INNOVA
111

Dimensions (in mm)

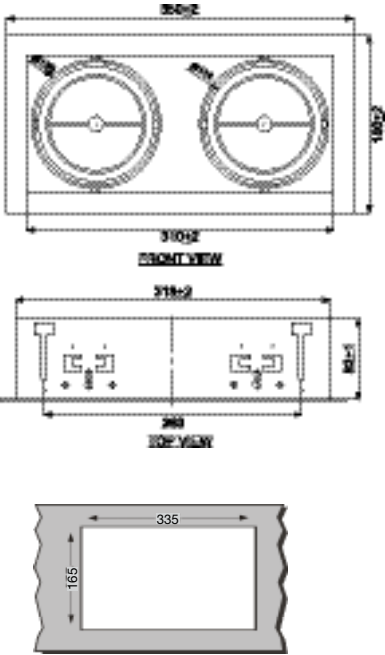

Specification

Housing
MS powder coated black housing with silver coated pressure die-cast aluminium ring and ring nut in silver ring. The arrangement provided for orientation of 45° in all direction.

Optics
The luminarie suitable for QR 111 and Innova 111 lamps with integrated reflector.

Lamp Holder
G53 / GU 5.3 type lamp holder with electrical grade copper contact.

Mounting
Fixed in false ceiling with suitable clamp arrangement provided as per instruction.

Applications

- Showrooms
- Restaurants
- Art Galleries
- Hotel Lobbies
- Car Showrooms
- Corridors & Passage Areas



Technical Details

Ordering Code	Lamp Type	Nominal Voltage (V)	Mains Current (A)	Lamp Socket	Power* Factor
LHOH80250399	2x50W QR111	240	0.80	G53	1.0
	or 2x18W INNOVA 111	240	0.26	GU 5.3	≥ 0.55

*Order suitable ballast for Innova 111 seperately.



GDL 62



Recess, swivel
modular downlighter
suitable for
3xQR111/ INNOVA
111

Dimensions (in mm)

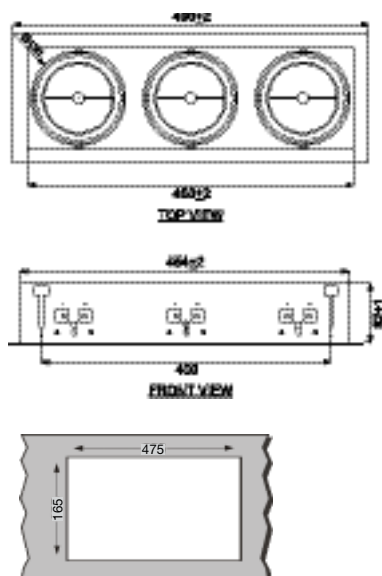

Specification

Housing

MS powder coated black housing with silver coated pressure die-cast aluminium ring and ring nut in silver ring. The arrangement provided orientation of 45° in all direction.

Optics

The luminaire suitable for QR 111 and Innova 111 lamps with integrated reflector.

Lamp Holder

G53 / GU 5.3 type lamp holder with electrical grade copper contact.

Mounting

Fixed in false ceiling with suitable clamp arrangement provided as per instruction.

Applications

Showrooms
Restaurants
Art Galleries
Hotel Lobbies
Car Showrooms
Malls and Retail Shops



Technical Details

Ordering Code	Lamp Type	Nominal Voltage (V)	Mains Current (A)	Lamp Socket	Power Factor*
LHOH80350399	3x50W QR 111	240	1.200	G53	≥1.0
	or 3x18W INNOVA 111	240	0.39	GU 5.3	≥ 0.55

*Order suitable ballast Innova 111 seperately.



GDL 63



Recess, swivel
modular downlighter
suitable for
4xQR111/ INNOVA
111

Dimensions (in mm)

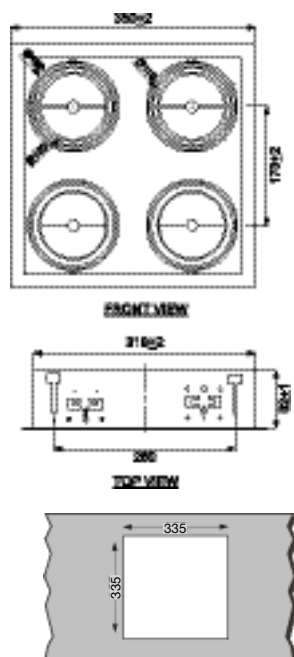

Specification

Housing

MS powder coated black housing with silver coated pressure die-cast aluminium ring and ring nut in silver ring. The arrangement provided orientation of 45° in all direction.

Optics

The luminarie suitable for QR 111 and Innova 111 lamps with integrated reflector.

Lamp Holder

G53 / GU 5.3 type lamp holder with electrical grade copper contact.

Mounting

Fixed in false ceiling with suitable clamp arrangement provided as per instruction.

Applications

Showrooms
Restaurants
Art Galleries
Hotel Lobbies
Car Showrooms
Malls and Retail Shops

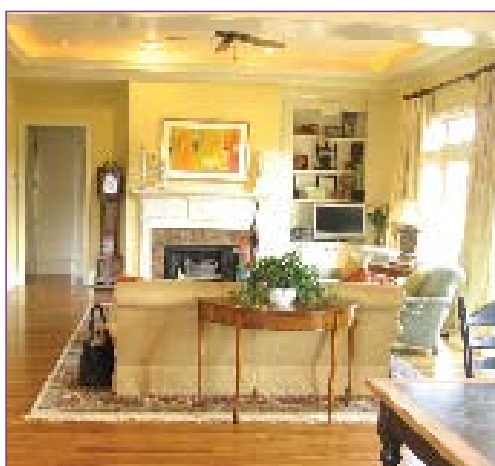

Technical Details

Ordering Code	Lamp Type	Nominal Voltage (V)	Mains Current (A)	Lamp Socket	Power Factor*
LHOH80450399	4x50W QR 111	240	1.600	G53	1.0
	or 4x18W INNOVA 111	240	0.55	GU 5.3	≥0.55

*Order suitable ballast Innova 111 separately.



GDL 64



Recess, swivel
modular downlighter
suitable for 1xMR16/
11W INNOVA

Dimensions (in mm)

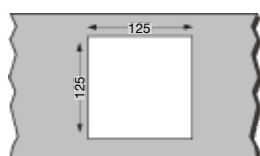
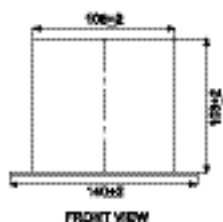
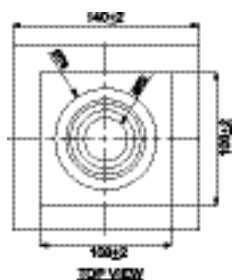

Specification

Housing

MS powder coated housing with pressure die cast aluminium ring and ring nut arrangement provides orientation of 45° in all direction.

Optics

Luminarie suitable 12V/50W MR16 Halogen lamp, INNOVA 11W CF lamps with integrated reflector.

Lamp Holder

GU 5.3 type lamp holder with electrical grade copper contact.

Mounting

Fixed in false ceiling with 2 nos SS spring arrangement provided as per instruction.

Applications

Showrooms
Restaurants
Art Galleries
Hotel Lobbies
Car Showrooms
Malls and Retail Shops
Corridors and Passage Areas

Technical Details

Ordering Code	Lamp Type	Nominal Voltage (V)	Mains Current (A)	Lamp Socket	Power* Factor
LHOH81150399	1x50W MR16	240	0.4	GU 5.3	1
	or 1x11W INNOVA	240	0.075	GU 5.3	≥ 0.60

*Order suitable ballast separately.



GDL 65



Recess, swivel modular downlighter suitable for 2xMR16/ 11W INNOVA

Dimensions (in mm)

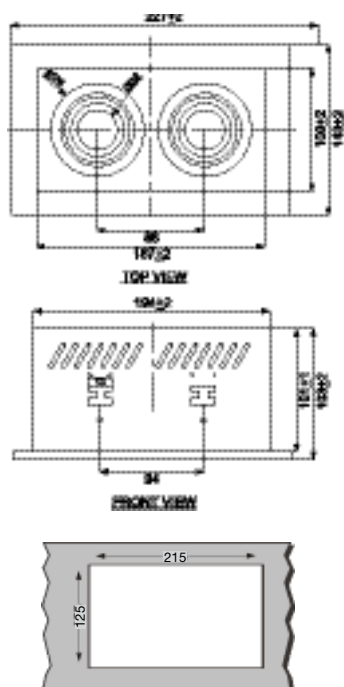

Specification

Housing

MS powder coated housing with pressure die cast aluminium ring and ring nut arrangement provides orientation of 45° in all direction.

Optics

Luminarie suitable for MR16 and 11W Innova lamps with integrated reflector.

Lamp Holder

GU 5.3 type lamp holder with electrical grade copper contact.

Mounting

Fixed in false ceiling with 4 nos SS spring arrangement provided as per instruction.

Applications

Showrooms
Restaurants
Hotel Lobbies
Malls and Retail Shops
Corridors and Passage Areas

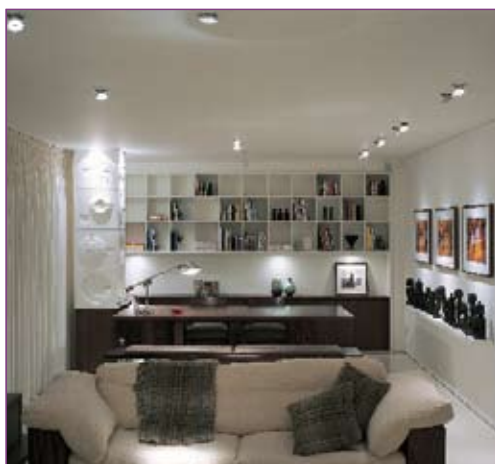

Technical Details

Ordering Code	Lamp Type	Nominal Voltage (V)	Mains Current (A)	Lamp Socket	Power* Factor
LHOH81250399 or	2x50W MR16	240	0.80	GU 5.3	1
	2x11W INNOVA	240	0.15	GU 5.3	≥ 0.60

*Order suitable ballast seperately.



GDL 66



Recess, swivel modular downlighter suitable for 3xMR16/ 11W INNOVA

Dimensions (in mm)

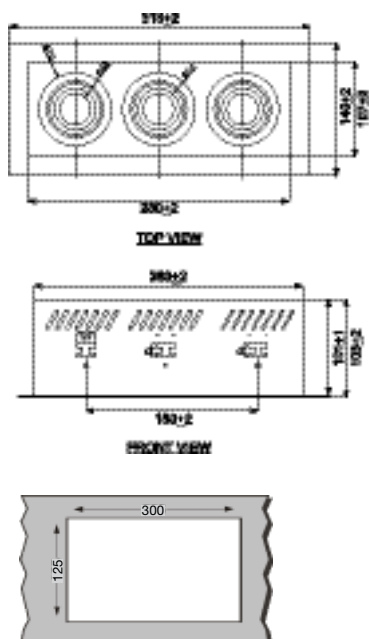

Specification

Housing

MS powder coated housing with pressure die cast aluminium ring and ring nut arrangement provides orientation of 45° in all direction.

Optics

Luminaire suitable for MR16 and 11W Innova lamps with integrated reflector.

Lamp Holder

GU 5.3 type lamp holder with electrical grade copper contact.

Mounting

Fixed in false ceiling with 6 nos SS spring arrangement provided as per instruction.

Applications

Showrooms
Restaurants
Hotel Lobbies
Malls and Retail Shops
Corridors and Passage Areas

Technical Details

Ordering Code	Lamp Type	Nominal Voltage (V)	Mains Current (A)	Lamp Socket	Power* Factor
LHOH81350399	3x50W MR16	240	1.2	GU 5.3	1
	or 3x11W INNOVA	240	0.23	GU 5.3	≥ 0.60

*Order suitable ballast seperately.

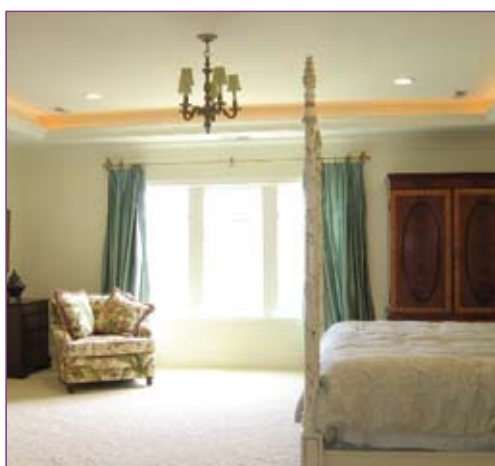

GDL 67



Recess, swivel modular downlighter suitable for 4xMR16/ 11W INNOVA

Dimensions (in mm)

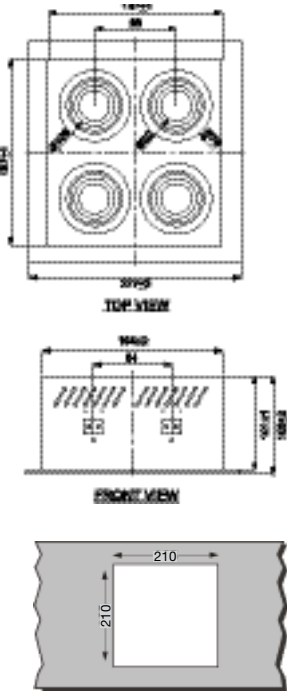

Specification

Housing
MS powder coated housing with pressure die cast aluminium ring and ring nut arrangement provides orientation of 45° in all direction.

Optics
Luminaire suitable for MR16 and 11W Innova lamps with integrated reflector.

Lamp Holder
GU 5.3 type lamp holder with electrical grade copper contact.

Mounting
Fixed in false ceiling with 4 nos SS spring arrangement provided as per instruction.

Applications

- Showrooms
- Restaurants
- Hotel Lobbies
- Malls and Retail Shops
- Corridors and Passage Areas



Technical Details

Ordering Code	Lamp Type	Nominal Voltage (V)	Mains Current (A)	Lamp Socket	Power* Factor
LHOH81450399	4x50W MR16 or 4x11W INNOVA	240	1.6	GU 5.3	1
		240	0.30	GU 5.3	≥ 0.60

*Order suitable ballast seperately.



GDL 31



Surface mounted sleek elegant compact integral fixture suitable for 2x18W PL-C

Dimensions (in mm)

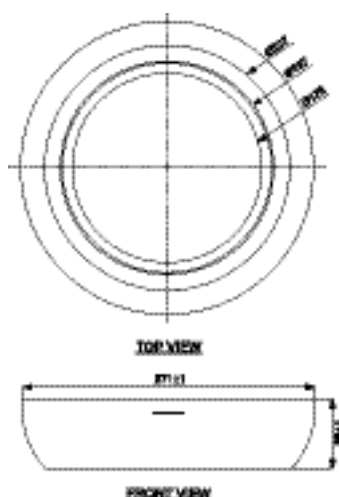

Specification

Housing

MS powder coated white housing with high purity anodized aluminium reflector and centre frosted glass fixed to the housing.

Optics

Spun aluminium reflector having specular finish with centre frosted lense for glare free light distribution

Lamp holder

G24-d3 lamp holder with electrical grade copper contacts.

Mounting

Fixed in false ceiling with 2 nos screws provided as per instruction.

Applications

Showrooms
Restaurants
Hotel Lobbies
Malls & Retail Showroom



Technical Details

Ordering code	Lamp Type Voltage (V)	Nominal Current (A)	Mains Socket	Lamp Factor	Power
LHOC15218420	2x18W PL-C	240	0.44	G24-d3	≥ 0.50

*With HF electronic ballast option power factor ≥ 0.90





Galerie
GAULTIER